

HangTight Banner Frame Clamp Bar Style Models

Installing The Banner

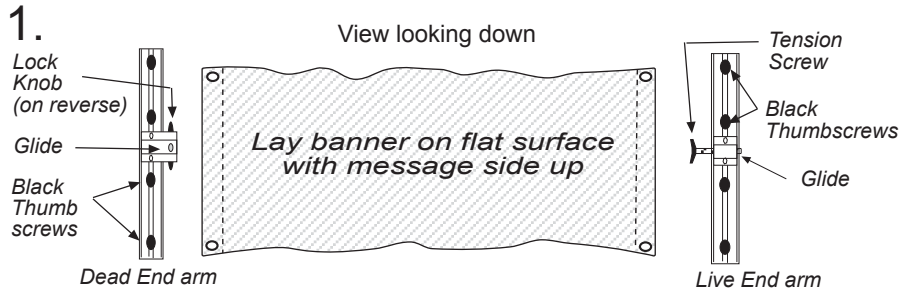

Lay out your banner and the Live End and Dead End arms as shown. The printed side of the banner should be facing up. The black Thumb screws of the arms should be facing up.

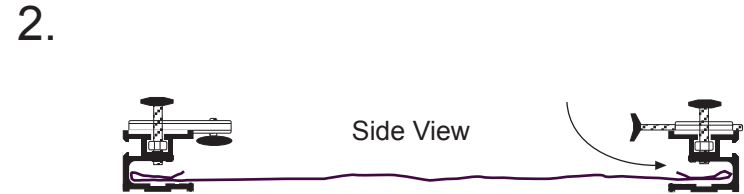

Make sure the black thumb screws are retracted far enough to allow room for the hemmed ends of the banner to be inserted into the wide opening of the arm. Slide the hemmed ends of the banner all the way back into the openings of both arms and tighten all "eight" of the black thumb screws firmly.



Next - turn arms away from center until they are upside down from their original position. The banner should now cover the arms and still be face up.



The banner is ready to be attached to the frame.

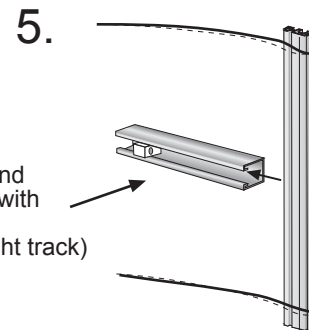
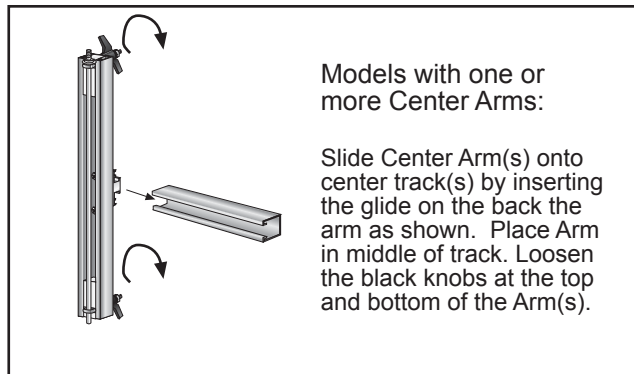

Pick up the Live End Arm - with the banner attached - fold it back and insert its Glide into the far right track. The banner will wrap across the front of the Arm, concealing it.

Slide the Live End Arm in until it hits the white plastic Stop inside the track.

Continued

6.

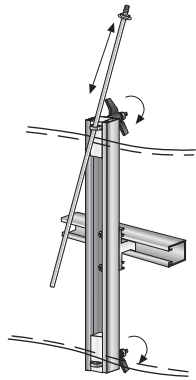

MODELS WITH ONE OR MORE CENTER ARMS :

Pull the banner leftward to the Center Arm(s). Slide the Retaining Rod(s) up far enough place the banner behind the Rod(s).

Reinsert the Rod(s) into the bottom eyelet(s), but do not tighten the black knobs on the back of the Arm(s) yet.

7.

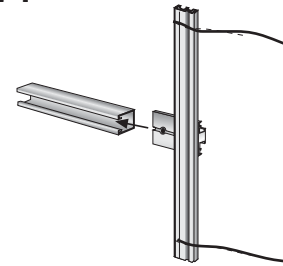

Pull the Dead End Arm all the way to the Dead End Track on the far left. Insert the Glide into the Track. The banner should conceal the arm, as shown.

8.

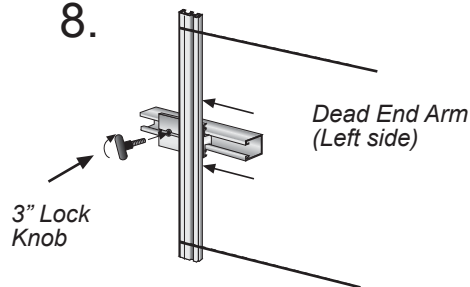

Dead End Arm (Left side)

3" Lock Knob

If not already done, screw the 3" Lock Knob into the glide on the Dead end (left) arm. Pull the Arm outward until the banner is as tight as you can get it, then tighten the Lock Knob to hold the Arm in place.

9.

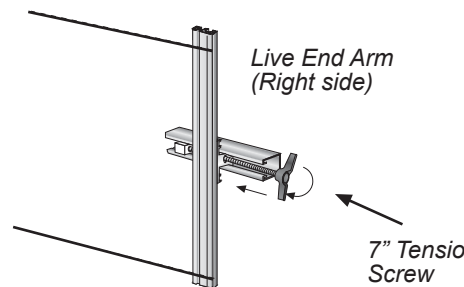

Live End Arm (Right side)

7" Tensio Screw

Wind the 7" Tension Screw clockwise until the banner becomes very taut.

10.

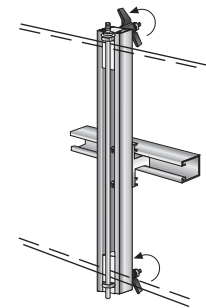

MODELS WITH ONE OR MORE CENTER ARMS :

After the banner is fully taut, tighten the knobs at the top & bottom of the Center Arm(s), pulling the Retaining Rod tight against the front of the banner.

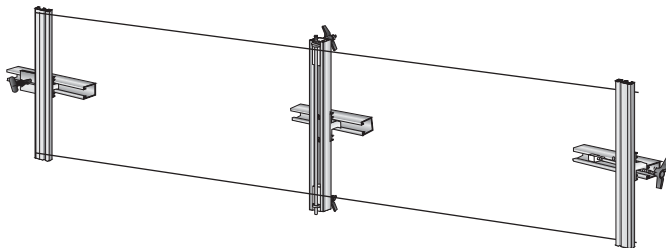

Your finished display should appear like this. The banner should be taut and straight across the top.

TO REMOVE BANNER:

1. Loosen Tension Screw on Live Arm
2. Loosen and remove Retaining Rods on Center Arms
3. Loosen Lock Knob on Dead Arm and slide arm inward & off the track
4. Remove any Center Arms from tracks
5. Remove Arm from Strongback
6. Loosen Thumb screws on Arms and remove banner.

**Questions?
Problems?**

**Call Voxpop at
1-800-386-9767**

or e-mail:
service@voxpathms.com

www.voxpopms.com